

# TAP In-Line Isolators

CASTECH supplies **TAP isolators** which have a power monitoring port, exporting light in constant proportion of the output power for easier detection. It supports various output ratios like  $0.1 \pm 0.05\%$ ,  $1 \pm 0.5\%$ ,  $2 \pm 0.8\%$ ,  $5 \pm 1.0\%$  and  $10 \pm 2.0\%$ , of course, the ratio can be customized as well.

CASTECH produces TAP in-line isolators with high isolation, high power handling, high return loss, low insertion loss, excellent environmental stability and high reliability, The connection types of the fiber tail can be bare fiber or FC/APC.



## Applications

- EDFA
- DWDM Systems
- Optical coherence detection
- Laser sensing
- Fiber communication

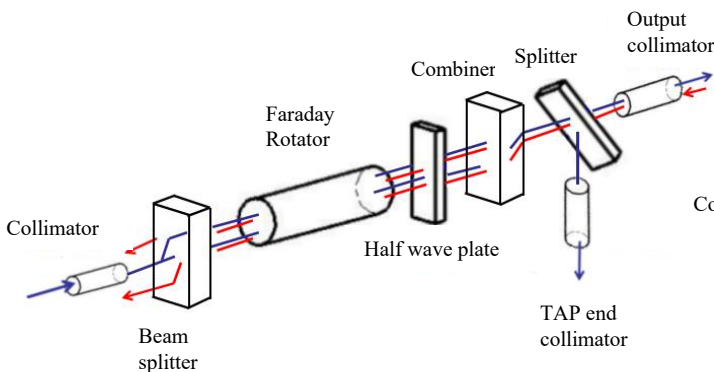

Non-Polarization-Maintaining TAP in-line Isolator

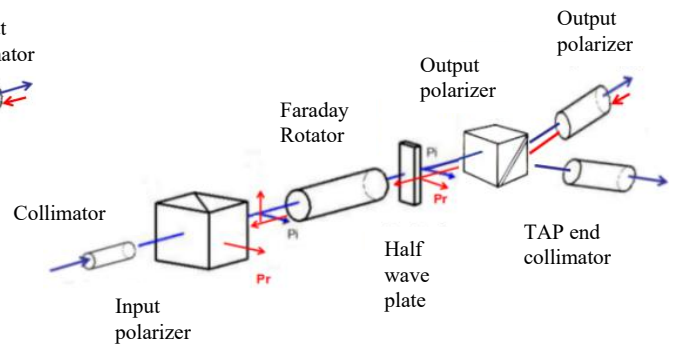

Polarization maintaining TAP in-line isolator

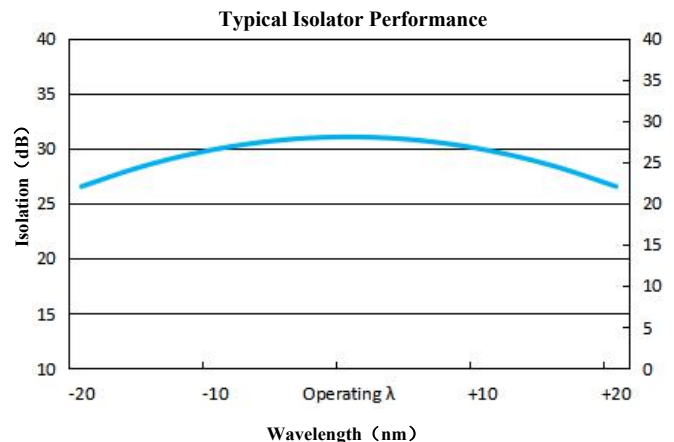
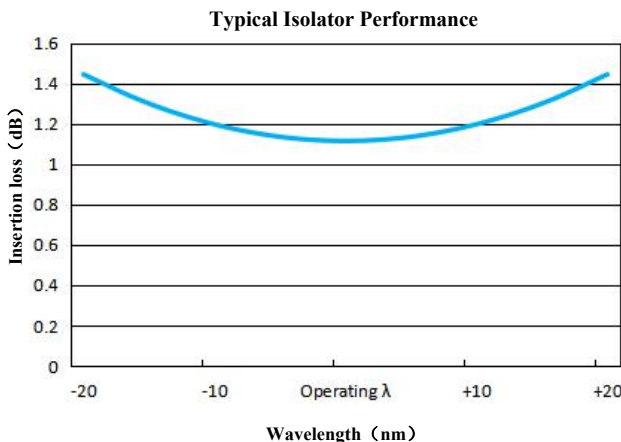

# TAP In-Line Isolators

## Non-Polarization-Maintaining Type Model Number: HPISO-t-p-f-λ-e-l-b-h

Type(t)	Power(p)	Fiber Type(f)	Wavelength (λ)	Pigtail Diameter(e)	Fiber Length(l)	Filter(b)	Housing(h)
TAP (With monitoring port)	0.3 W 5 W 30 W 50 W ...	1 (HI1060) 2 (10/125SCF) 3 (20/130DCF) 4 (12/250DCF) 5 (20/250DCF) 6 (30/250DCF) ...	980 nm 1030 nm 1064 nm 1940 nm ...	L (900 μm Loose Tube) B (3 mm Loose Tube)	1 (1 m) 2 (1.5 m) ...	C (Contained) N (Not contained)	A23 ...

### Typical Specifications

Withstand Power	Insertion Loss	Peak Isolation
10 W	≤1.2 dB	>30 dB
50 W	≤1.2 dB	>30 dB

Operating temperature range: 10°C-30°C.

### Housing dimensions(mm):

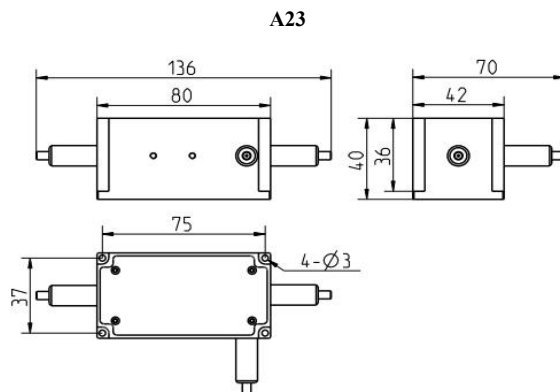

# TAP In-Line Isolators

## Polarization-Maintaining Type Model Number: HPISO-t-p-f-λ-e-l-b-h

Type(t)	Power(p)	Fiber Type(f)	Wavelength (λ)	Pigtail Diameter(e)	Fiber Length(l)	Filter(b)	Housing(h)
TAP (With monitoring port)	0.3 W 5 W 30 W 50 W ...	7 (PM 980) 8 (PM10/125SCF) 9 (PM20/130DCF) ...	980 nm 1030 nm 1064 nm 1940 nm ...	L (900 μm Loose Tube) B (3 mm Loose Tube)	1 (1 m) 2 (1.5 m) ...	C (Contained) N (Not contained)	A15 ...

## Typical Specifications

Withstand Power	Extinction Ratio	Insertion Loss	Peak Isolation
10 W	<20 dB	≤1.5 dB	>30 dB
50 W	<20 dB	≤1.5 dB	>30 dB

Operating temperature range: 10°C-30°C.

## Housing dimensions(mm):

